

Access

Kagurazaka Campus, Tokyo University of Science (1-3 Kagurazaka, Shinjuku-ku, Tokyo 162-8601)

- 5 minutes' walk from "Iidabashi Station" west gate, accessible via the JR Sobu Line,
- 3 minutes' walk from "Iidabashi Station" B2a/B3 gate, accessible via the Tokyo Metro Yurakucho, Tozai, and Namboku Lines, and the Toei Subway Oedo Line.

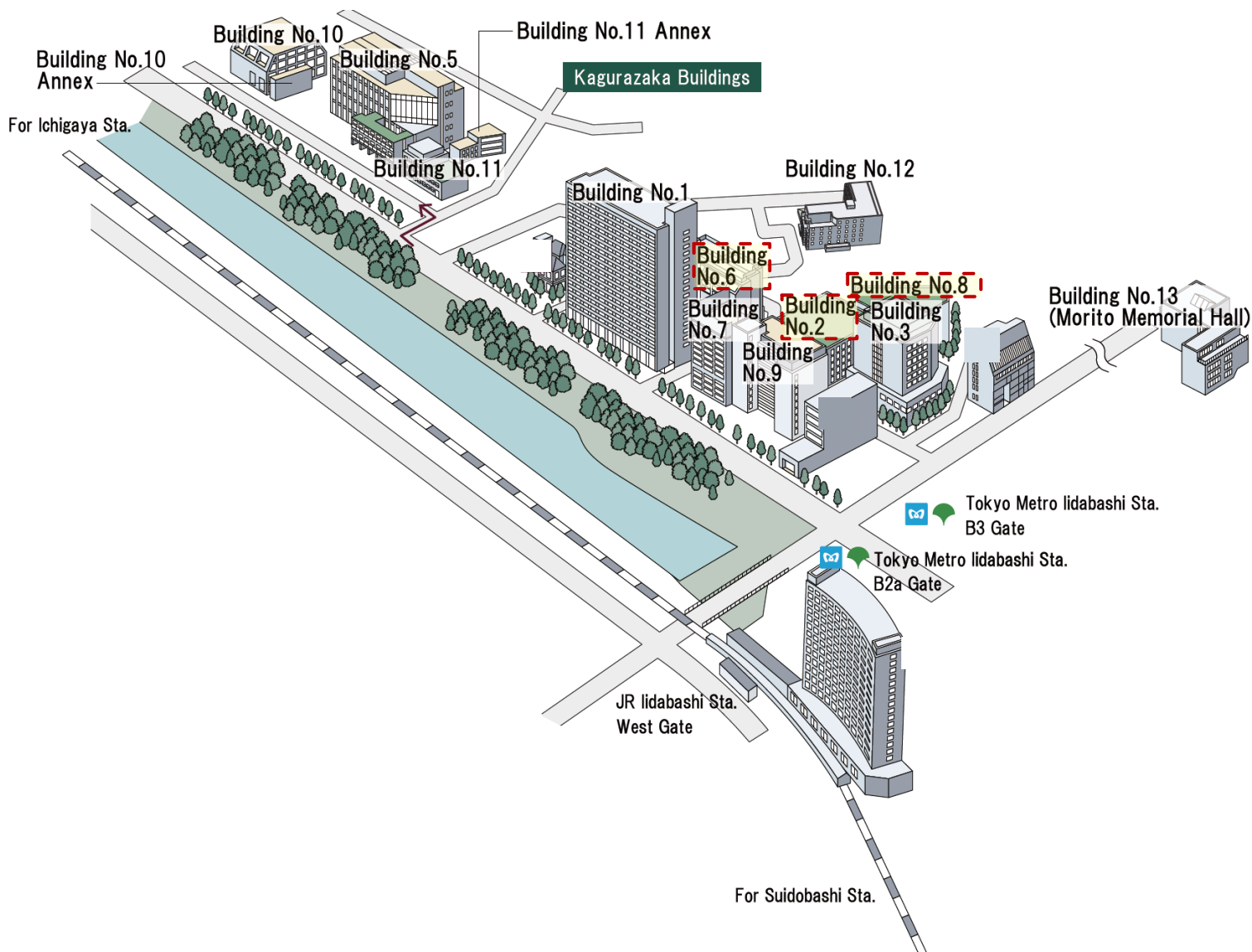

Access

Kagurazaka Campus, Tokyo University of Science (1-3 Kagurazaka, Shinjuku-ku, Tokyo 162-8601)

- 5 minutes' walk from "Iidabashi Station" west gate, accessible via the JR Sobu Line,
- 3 minutes' walk from "Iidabashi Station" B2a/B3 gate, accessible via the Tokyo Metro Yurakucho, Tozai, and Namboku Lines, and the Toei Subway Oedo Line.

Building No.6

Poster Session
Sep. 3, PM, Room 624

Building No. 2 and 8 (connected on each floor)

OS, General talk, Award ceremony,
Invited talks (PM Sep. 3, 1st floor, Building No.2)
Main Office (Room 224, 2nd floor, Building No.2)
Cafeteria (1st/2nd floor, 11:00AM~2:30PM)

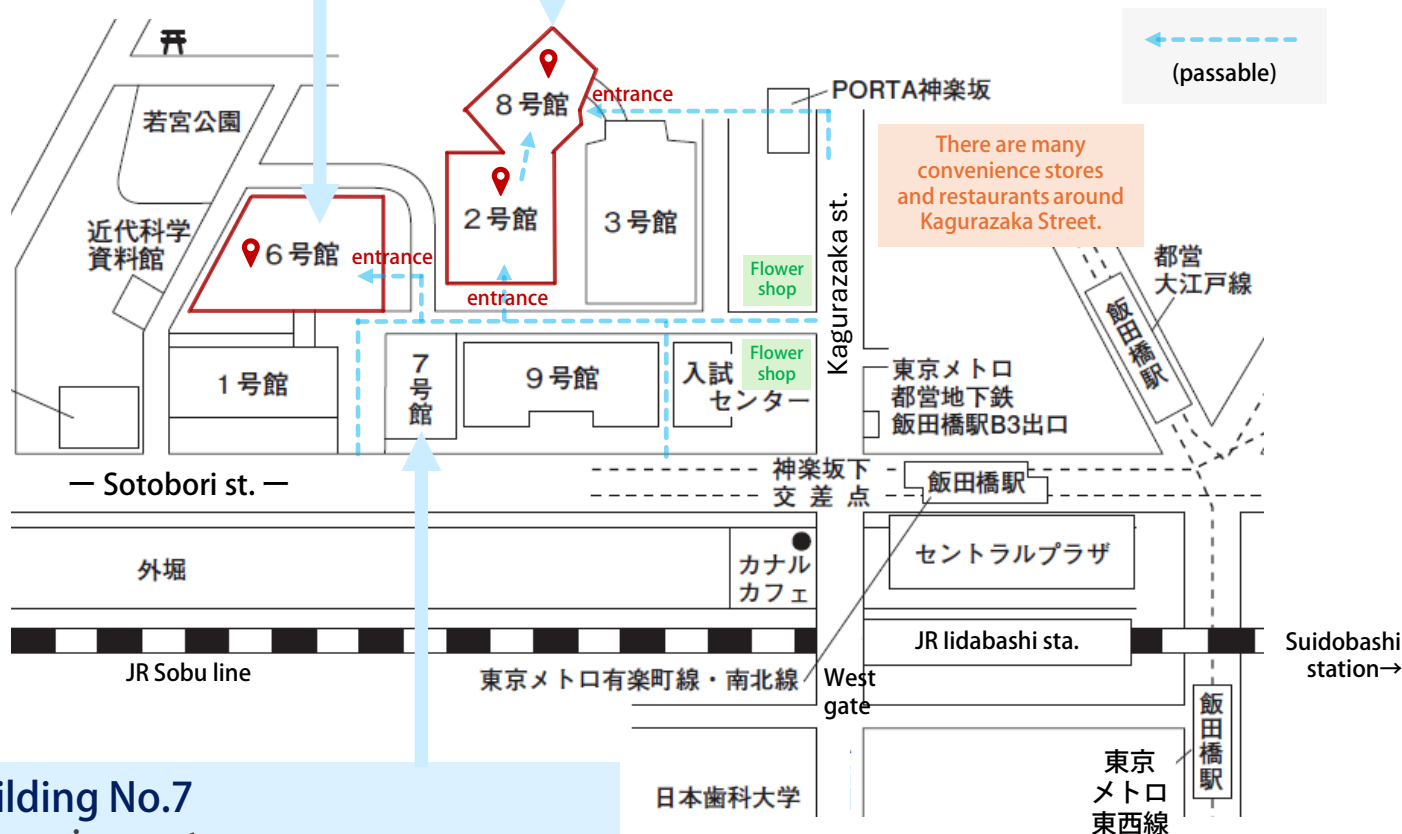

Building No.7

convenience store
(1st/2nd floor, 11:00AM~16:00PM)

Please be sure to bring your printed participation certificate on A4 paper to the venue

- ✓ If you have a participation certificate, please pick up a name tag at the entrance of Building No. 2 and proceed to the venue (no reception required).
- ✓ If you have forgotten your participation certificate, please come to the main office (Room 224, 2nd floor of Building No. 2).

1st floor, Building No. 2 and 8

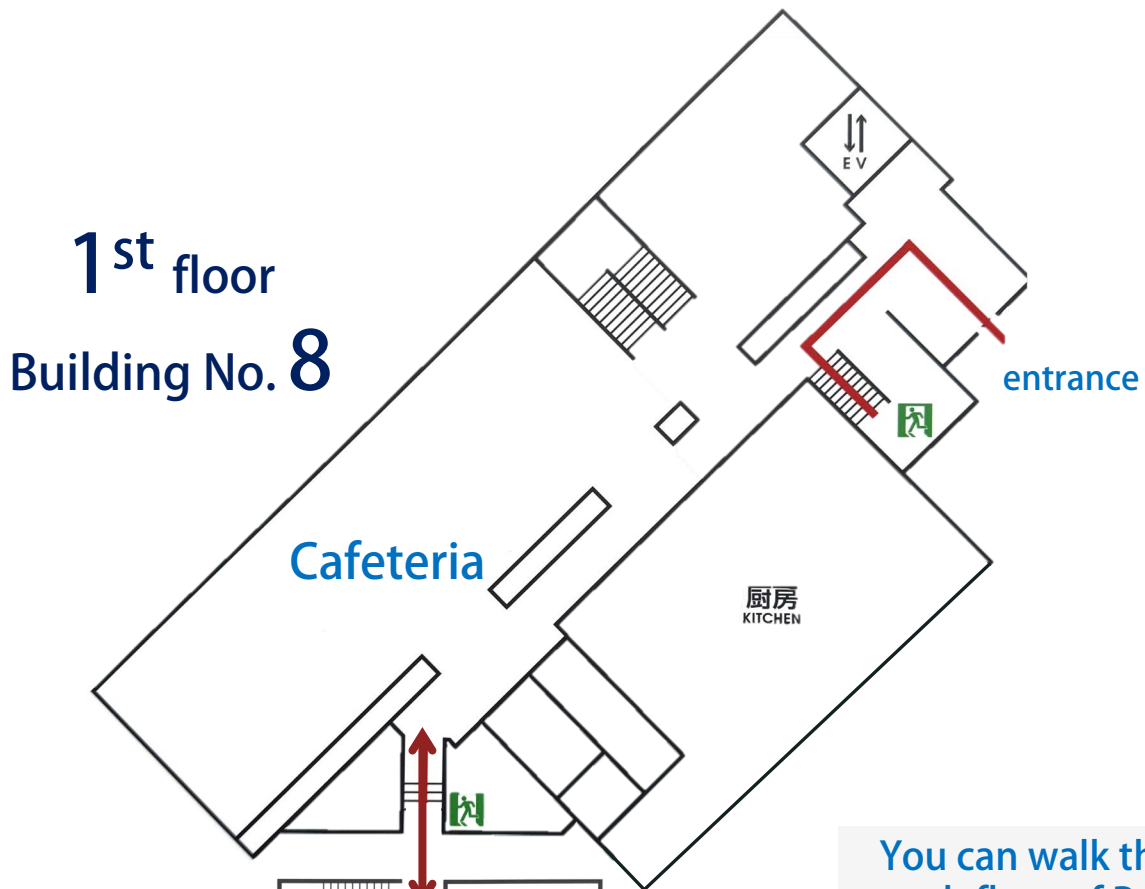

You can walk through
each floor of Building
No. 2 and 8

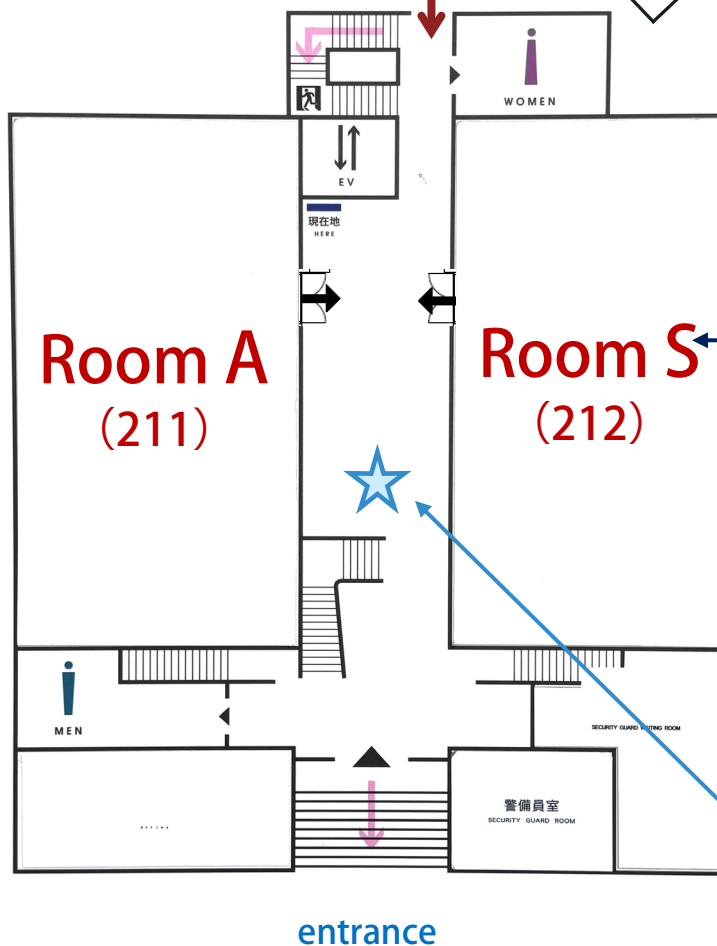

On September 2 and 4,
this area will be used as a
break lounge (power
outlets available).

1st floor
Building No. 2

Name tags will be distributed here,
so please bring your participation
certificate printed on A4 size paper.

| 2nd floor, Building No. 2 and 8



| 3rd floor, Building No. 2 and 8



You can walk through
each floor of Building
No. 2 and 8

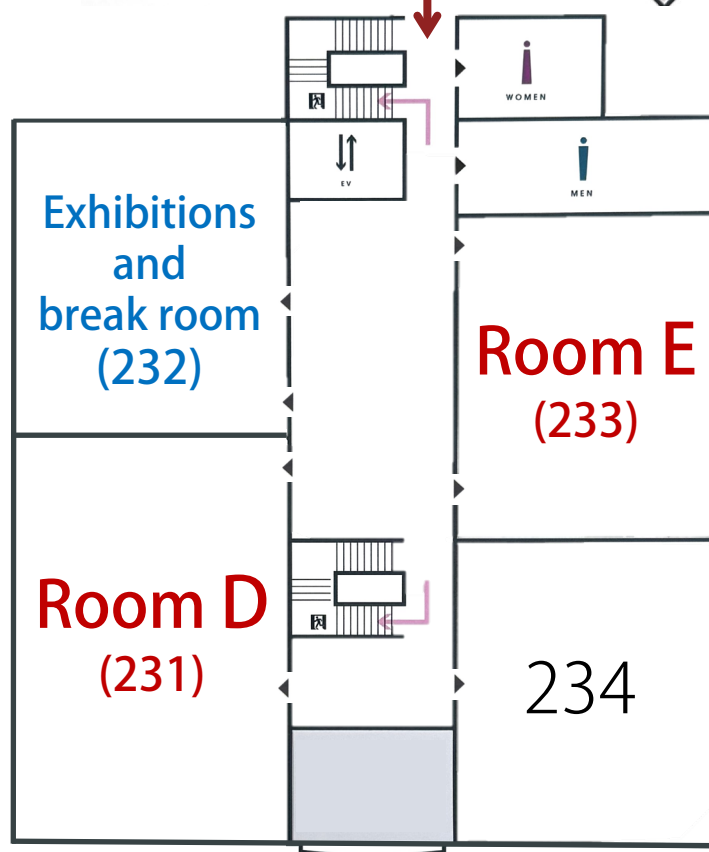

3rd floor
Building No. 2

| 4th floor, Building No. 2 and 8

4th floor
Building No. 8



You can walk through
each floor of Building
No. 2 and 8



4th floor
Building No. 2

| 2nd floor, Building No. 6

Poster Session

Sep. 3, 13:00PM--14:20PM

2nd Floor, Building No. 6 *The entrance is on the second floor.

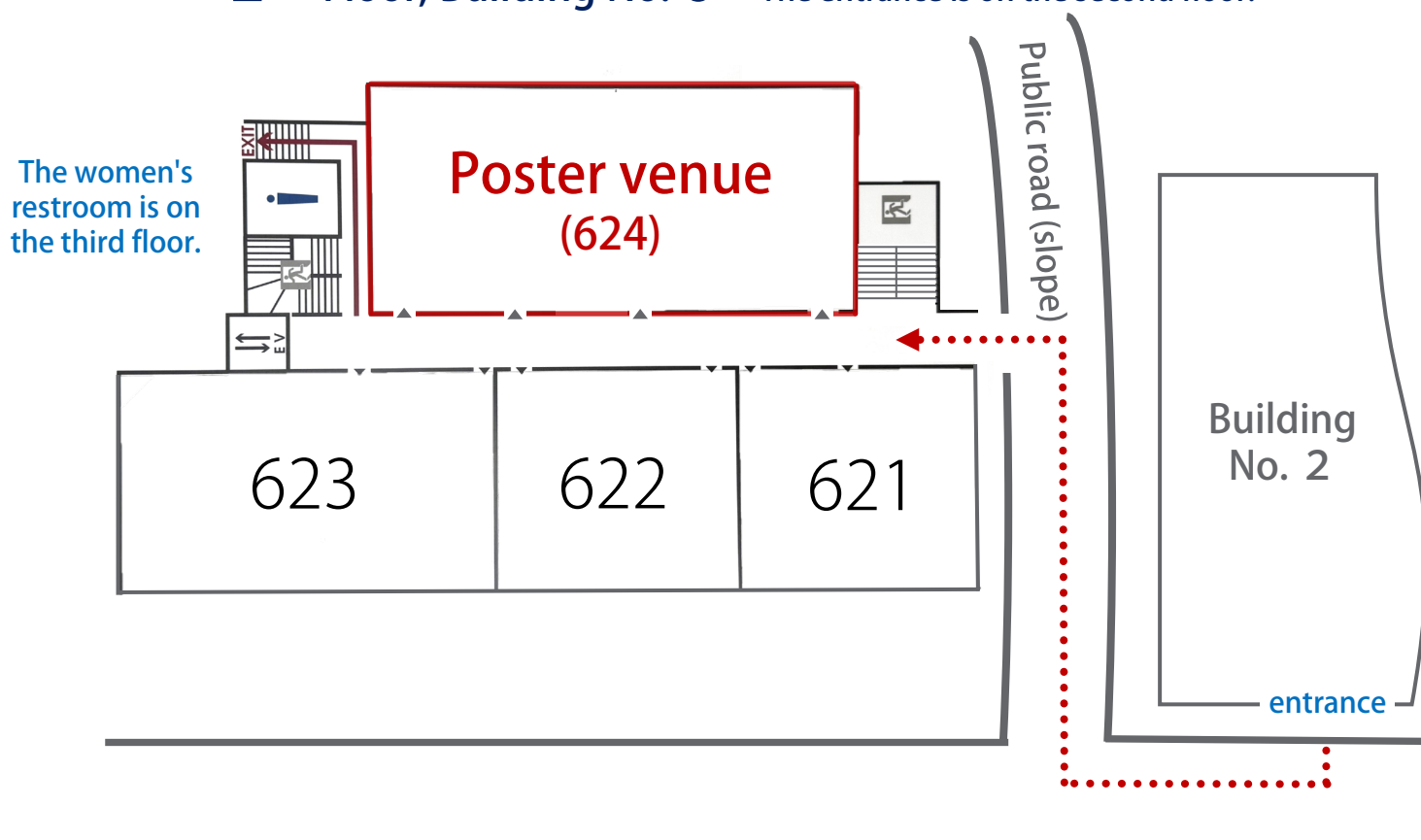

Banquet

A banquet will be held as follows. We hope you will join us.
Please register in advance, wear your name tag, and come to the venue.

Please note that we cannot accept applications for participation at the venue on the day of the banquet.

■ Date: Sep. 3, 18:30PM--20:30PM (registration begins at 18:00)

■ Venue: Arcadia Ichigaya, 3rd Floor, Room "Fuji" (富士)

<https://www.arcadia-jp.org/eng/>

Approximately 20 minutes walk from the annual meeting venue.

2 minutes walk from Ichigaya Station (One stop from Iidabashi Station).

■ アルカディア市ヶ谷 私学会館 地図・交通のご案内 ■



交通のご案内

地下鉄 有楽町線・南北線 市ヶ谷駅 (1またはA1)出口から徒歩2分

地下鉄 新有楽町線 市ヶ谷駅 (A1またはA4)出口から徒歩2分

JR 中央線 (各駅停車) 市ヶ谷駅から徒歩2分

